

AIR BALANCER RAIL SYSTEM



ENDO ENDO KOGYO CO.,LTD
ENDO KOGYO CO.,LTD.

3-14-7, Akibacho, Tsubame, Niigata, Japan
TEL : +81-256-62-5131 FAX.+81-256-62-5772

<http://www.endo-kogyo.co.jp/>

ENDO ENDO KOGYO INDIA PVT.,LTD
ENDO KOGYO INDIA PVT.,LTD.

202, Winners Court, Plot No.23,
Sahani Sujan Park, Main Lulla Nagar, Pune-411040
TEL : +91-20-41200624

<http://www.endo-india.co.jp/>



CERT. JP97/10458QA
SCOPE : Head office, Plant



ISO14001 JP10/070952
SCOPE : Head office, Plant

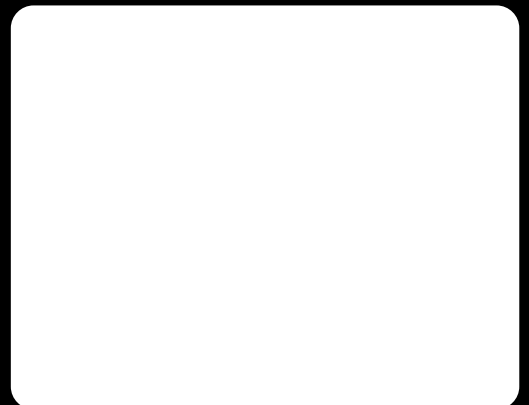

Type- **MS-A** Hoisting with down stop

AIR BALANCER is handling equipment whose power source is compressed air.

- **Adjustment of lifting and lowering speed**

Both speeds are adjustable by turning the knob on control module.

- **Floating capability**

By adding or reducing force directly onto the hanged load, the load will move down or up respectively. The range of floating is about 35cm up and down from stable position.



Grip for operation

Pendant for operation

Grip for operation

EHB-85 MS-AG



EHB-85 MS-A

Control module	model	hose	operation	weight
hoisting	MS-A	straight hose × 3	pendant	3.5kg
hoisting	MS-AG	coil hose × 3	grip	5kg

Specification

model	Air pressure (MPa)	Max lifting capacity (kg)	Stroke (m)	weight (kg)	Cable dia (mm)	Air inlet
EHB-50	0.7	55	1.9	28	φ 4.76	Rc 3/8
	0.6	48				
	0.5	40				
	0.4	32				
EHB-85	0.7	90	1.9	29	φ 4.76	Rc 3/8
	0.6	75				
	0.5	62				
	0.4	50				
EHB-130	0.7	140	1.9	36	φ 4.76	Rc 3/8
	0.6	120				
	0.5	100				
	0.4	80				



- **Grip type controller**

Grip type controller allows a more sensitive control of height of lift.

- **Down stop**

Added safety measure. Hanged load will not fall even if the air supply is cut off or when hoses are broken.

- **Energy-saving design**

Air consumption of AIR BALANCER is only 1/7 of that of AIR HOIST. (comparing our existing model)

- **Clean design**

No lubrication is needed and produces no oil mist.

- **Quiet design**

With no air motor, AIR BALANCER produces very little noise in operation.

Type-MS Hoisting without down stop

● Adjustment of lifting and lowering speed

Both speeds are adjustable by turning the knob on control module

● Floating capability

By adding or reducing force directly onto the hanged load, the load will move down or up respectively. The range of floating is about 35cm up and down from stable position.



Control module	model	hose	operation	weight
hoisting	MS	straight hose×2	pendant	2kg

Specification

model	Air pressure (MPa)	Max lifting capacity (kg)	Stroke (m)	weight (kg)	Cable dia (mm)	Air inlet
EHB-50	0.7	55	1.9	28	φ 4.76	Rc 3/8
	0.6	48				
	0.5	40				
	0.4	32				
EHB-85	0.7	90	1.9	29	φ 4.76	Rc 3/8
	0.6	75				
	0.5	62				
	0.4	50				
EHB-130	0.7	140	1.9	36	φ 4.76	Rc 3/8
	0.6	120				
	0.5	100				
	0.4	80				

POINT

● Economical model

● energy-saving design

Air consumption of AIR BALANCER is only 1/7 of that of AIR HOIST. (comparing our existing model)

● Clean design

No lubrication is needed and produces no oil mist.

● Quiet design

With no air motor, AIR BALANCER produces very little noise in operation.

Type-ABC Full auto module

● Auto Balance

With Full auto module, the AIR BALANCER can automatically adjust itself to the weight of the hanged load. The load can then be lifted and lowered by hand without using the controller.

● Adjustment of lifting and lowering speed

Both speeds are adjustable by turning the knob on control module.

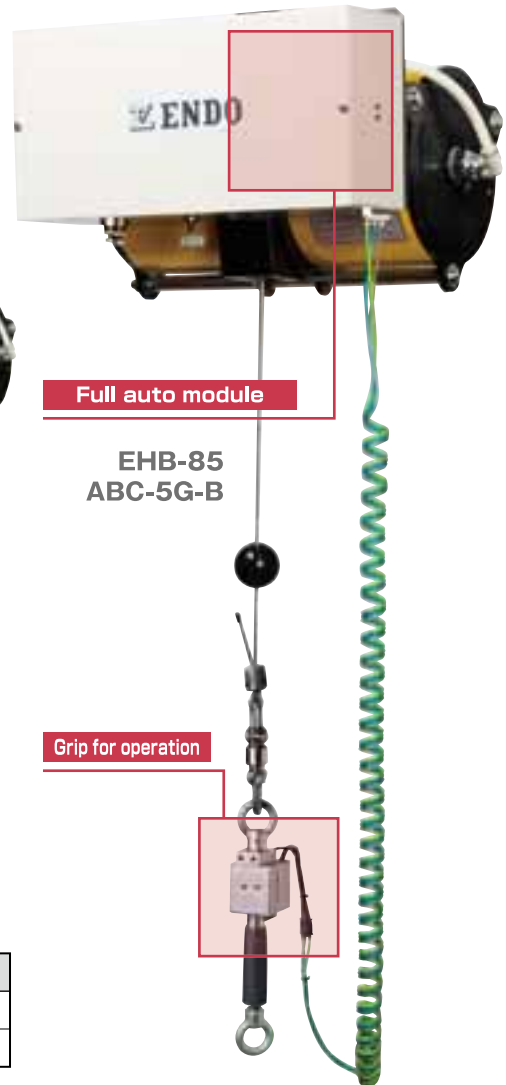

Control module	model	hose	operation	weight
Full auto module	ABC-5P-B	coil hose×3	pendant	11kg
Full auto module	ABC-5G-B	coil hose×3	grip	11kg

Specification

model	Air pressure (MPa)	Max lifting capacity (kg)	Stroke (m)	weight (kg)	Cable dia (mm)	Air inlet
EHB-50	0.5	40	1.9	28	φ 4.76	Rc 3/8
	0.4	30				
	0.3	20				
EHB-85	0.5	60	1.9	29		
	0.4	45				
	0.3	30				
EHB-130	0.5	85	1.9	36		
	0.4	62.5				
	0.3	40				



● Auto balance

Full auto module can recognize the weight of hanged device from 0kg to Max lifting capacity so that the balancing can be controlled.

● Down stop

Hanged device is not falling down even if the air supply is cut off.

● Energy-saving design

Air consumption of AIR BALANCER is only 1/7 of that of AIR HOIST. (comparing our existing model)

● Clean design

No lubrication is needed and produces no oil mist.

● Quiet design

With no air motor, AIR BALANCER produces very little noise in operation.

Type-MSD Hoisting with inertia prevention unit

Adjustment of lifting and lowering speed

Both speeds are adjustable by turning the knob on control module.



EHB-85D MSD

Control module MSD

Pendant for operation

Inertia prevention unit

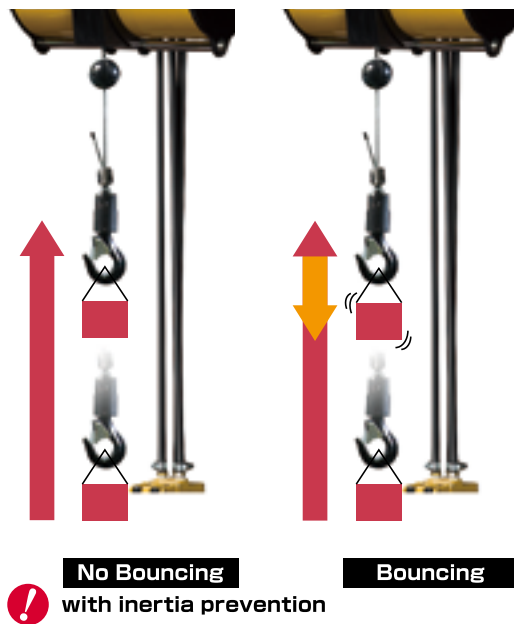

No Bouncing with inertia prevention

Bouncing

Control module	model	hose	operation	weight
hoisting	MSD	straight hose×3	pendant	6kg

Specification

model	Air pressure (MPa)	Max lifting capacity (kg)	Stroke (m)	weight (kg)	Cable dia (mm)	Air inlet
EHB-85D	0.7	90	1.9	38	φ4.76	Rc 3/8
	0.6	75				
	0.5	62				
	0.4	50				



Inertia prevention unit

Accurate positioning by pendant control is made possible. (Brake eliminates the bouncing effect)

Down stop

Hanged device is not falling down even if the air supply is cut off.

Energy-saving design

Air consumption of AIR BALANCER is only 1/7 of that of AIR HOIST. (comparing our existing model)

Clean design

No lubrication is needed and produces no oil mist.

Quiet design

With no air motor, AIR BALANCER produces very little noise in operation.

JIB CRANE

● Rail system for less space

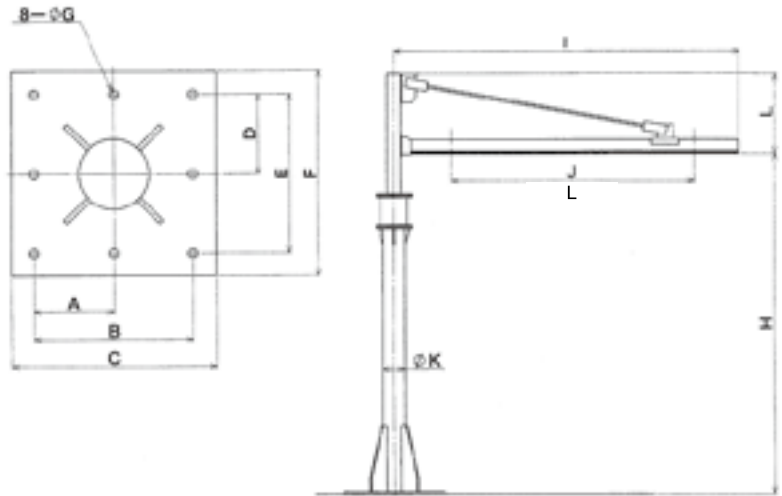

Dimensions

model	A (mm)	B (mm)	C (mm)	D (mm)	E (mm)	F (mm)	G (mm)	H (mm)	I (mm)	J (mm)	K (mm)	L (mm)	weight (kg)
EJS-2-20-300	230	460	500	230	460	500	φ20	2,000	2,095	1,140	φ216.8	700	300
EJS-2-30-265	230	460	500	230	460	500	φ20	3,000	2,095	1,315	φ216.8	700	265
EJS-3-20-170	230	460	500	230	460	500	φ20	2,000	3,095	2,235	φ216.8	900	170
EJS-3-30-150	230	460	500	230	460	500	φ20	3,000	3,095	2,235	φ216.8	900	150
EJB-2-20-400	280	560	600	280	560	600	φ20	2,000	2,110	1,140	φ267.4	700	400
EJB-2-30-400	280	560	600	280	560	600	φ20	3,000	2,110	1,140	φ267.4	700	400
EJB-3-30-250	280	560	600	280	560	600	φ20	3,000	3,110	2,235	φ267.4	900	250
EJB-4-30-120	280	560	600	280	560	600	φ20	3,000	4,110	3,235	φ267.4	900	120

※more models are available. Feel free to ask us.

Attachment

■ Pantagraph type



■ 2 point hook type

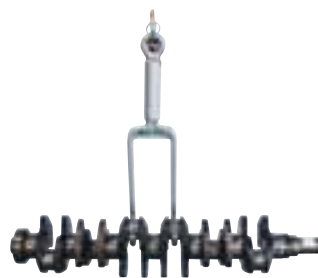

※we can customize for your request.

An excellent transfer system employing the benefits of aluminum and rail system

- ① Great movability. Enables load transfer with the shortest distance travel and thus faster working time.
- ② Standardization for parts makes it easy for relocation and expansion.
- ③ The parts come with kits and are joint using bolts; easy to assemble and repair.
- ④ Compared to steel rail, aluminum is lighter and stronger. With anodized treatment, our aluminum rails are more corrosive resistant, more durable, and looks better.
- ⑤ Precision machining on our rails and resin wheels allow smooth travel with little friction.



Aluminum alloy rail

Model	measurement (mm)	unit weight	rail length
TR2000		3.6kg/m	2inch
RAD4110		6.44kg/m	4inch
RAD7510		12.26kg/m	8inch

There are various trolley suited to your needs. Special trolleys are available for 2, 4 and 8 inch rails. Maximum loadings are;
 2 inch ... 180kg
 4 inch ... 250kg
 8 inch ... 490kg

Relation between lifting span and lifting load Kgf

rail length	TR2000	RAD4110	RAD7510
	Lifting load	Lifting load	Lifting load
1m	200	500	500
2m	100	500	500
3m	45	250	500
4m	25	140	500
5m	16	90	470
6m	11	60	330

How To Order

BODY

EHB-50
EHB-85
EHB-130



MODULE

MS-A
MS-AG
MS
ABC-5P-B
ABC-5G-B



TOP

HOOK
TROLLEY



READY TO ORDER

EHB-85D



MS-D



HOOK
TROLLEY



READY TO ORDER

Accessories

EHB Trolley



Part No.
LHP001899
Applicable width of beam
75mm, 100mm

Dimensions

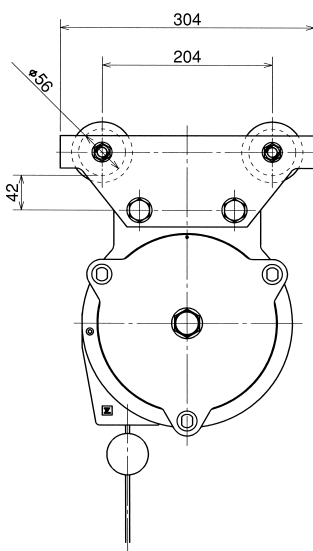

EHB Hook set



For MS · MS-A Part No.
LHP001900
For MSD · ABC Part No.
LHP001991

Dimensions

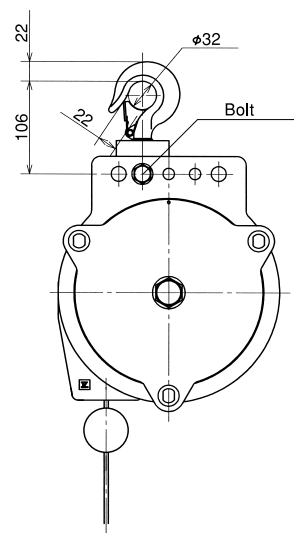

※Dimensions of LHP001900 and LHP001991 are same, but bolt length is different.

Dimensions

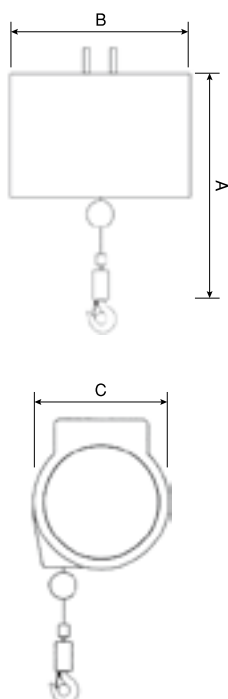

Model	Module	Dimensions (mm)			
		A		B	C
		MIN.	MAX.		
EHB-50	MS	526	2426	473	211
	MS-A	526	2426	498	211
	MS-AG	831	2731	498	211
	ABC-5P-B	526	2426	516	345
	ABC-5G-B	719	2619	516	345
EHB-85	MS	570	2470	466	252
	MS-A	570	2470	491	252
	MS-AG	875	2775	491	252
	ABC-5P-B	570	2470	516	385
	ABC-5G-B	763	2663	516	385
EHB-130	MS	652	2552	469	305
	MS-A	652	2552	494	305
	MS-AG	957	2857	494	305
	ABC-5P-B	652	2552	516	439
	ABC-5G-B	845	2745	516	439
EHB-85D	MSD	570	2470	520	326